

APPLICATION FOR SEWAGE PERMIT

Bremerton-Kitsap County Health Dist.

W/E Ready

| | |
|--------------------------|---------|
| Sewage Permit # | 07078 |
| Issue Date | 5-24-95 |
| Expiration Date | |
| Fees Paid \$ | 12509/m |
| Additional Inspection \$ | |

TW
Northwest Cascade, Inc 848-2371
 Name of Installer Phone

P.O. Box 73399 Puyallup 98373
 Address

Solid Seven Const
 Name of owner

1917 NE Cady St Bremerton 98310
 Address

Indicate type of system: New Repair Alteration

- Gravity
- Pressure Distribution
- Pressure Mound
- Sandfilter
- Other _____

same 10-31-94
 Name on building site application and date approved

5244-000-015-0008
 Assessors' Account Number

13800-Twilight Pl NW Silverdale
 Property Address and DIRECTIONS FOR LOCATING from nearest intersection

New Building (Building permit # 65359) Existing (A construction plan is required)
 Type of Occupancy: Residential Commercial* Single Family Multi-Family
 *(Hazardous Waste Requirements May Apply)

Number of Units 1 Number of Bedrooms per Unit 3

I hereby agree to comply with all the requirements of the Bremerton-Kitsap Co. Board of Health relating to sewage disposal. (The applicant has the right to appeal decisions of the health district.)

Edw A Bell Thomas V. Rogers
 Signature of Installer

Is there a sewer within 200 feet of the property? _____

HEALTH DISTRICT/FIELD DRAWING (Attach construction plan if a repair)

no system will require additional maintenance. contact this health district for details.

3 feet head press.

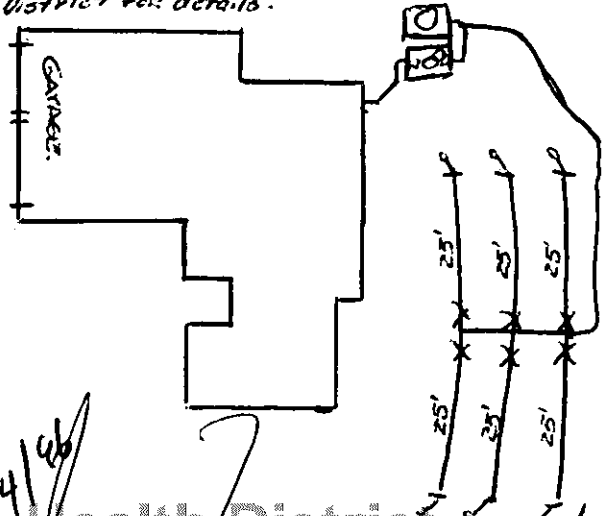

SM
4/26

5244-000-015-0008
 SOLID SEVEN CONST.
 13800 TWILIGHT PL NW
 04 25 1E

Installation Approved by: _____ Date 6/15/95 'As Built' Requested Yes No

(Health District Copy)

Solid Seven Const.

Bremerton Kitsap County Health Dept. 478-5285

MAY 13 1992

Lot # 15 Valley Hill 64860

OWNER: John Loid Hammer LEGAL: -OFF CLEAR Creek Rd

ADDRESS: 7412 Stampede Blvd NW Bremerton WA 98310
 Single Fam. Resid. No. Bedrooms 3 New Constr. Remodel
 Multi-fam. Resid. No. Units: Exist. Bldg. Basement
 Mobile Home: new replacement Commercial
 Moved Bldg. Drainfield repair design Other

Indicate soil type, texture/description, restrictive layer, mottling, Perc. & Loading Rates, place plot plan and vicinity map on reverse side.
 SOIL LOG # 1 <PRIMARY DRAINFIELD> SOIL LOG # 2

LR: .8 gpd/ft

LR: .8 gpd/ft

| Depth | Soil Type & Description |
|------------|--------------------------|
| 0" | Reddish Brown Loamy SAND |
| 24" 32" | Some Gravel |
| 36" | Compact |

| Depth | Soil Type & Description |
|------------|--------------------------|
| 0" | Reddish Brown Loamy SAND |
| 24" 32" | Some Gravel |
| 36" | Compact |

| LOG #3 | <FOR RESERVE> | LOG #4 | Perc. rates |
|---------------|---------------|------------------|-------------|
| LR: .8 gpd/ft | | LR: _____ gpd/ft | min/inch |
| 0" | Reddish Brown | | P-1 |
| 24" 32" | Loamy SAND | | P-2 |
| 36" | Compact | | P-3 |
| | | | P-4 |
| 48" | | | Ave |

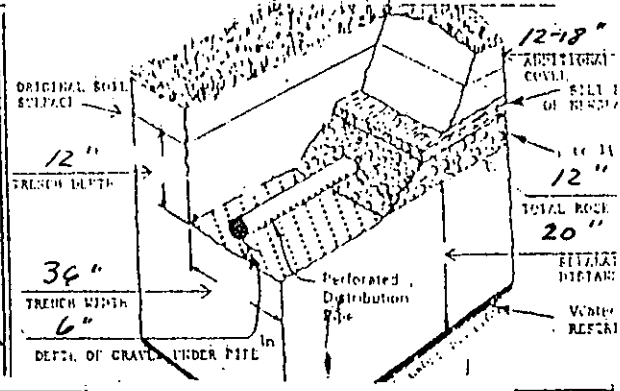

A. Depth to anticipated max. water table $\geq 32"$ % slope in DF. area $0-10\%$

B. The anticipated SEWAGE FLOW based on 120 gpd/bedroom is: 360 gpd. (B)

C. Loading rate average of SL #1 & SL #2 = $.8$ } Ave. LR = $.8$ gpd/ft (E)

D. Average perc. rate = loading rate of DRAINFIELD:
 $B / E = 4500$ Sq. ft. of drainfield / 2 = $225'$ lineal ft. required for standard 2 ft wide drainfield trench or $150'$ ft. DF. for 3ft trench.

$12-18"$ inches of fill is needed. $12-18"$ inches of cover over original ground. CURTAIN DRAIN: is not required. is required.

WATER SUPPLY IS Private or public supply of Silverdale H₂O with connections authorized by _____

B.S.A./DESIGN submitted by Dan A. [Signature] 612-3193 on 4-25 1992 water system representative

Lot 15 Valley Hill
Loid Hammer, John
5244-000-015-0008

SEWAGE DISPOSAL SYSTEM:

WATER SUPPLY:

ACCEPTED
6/25/92

ACCEPTED
[Signature]

Kitsap County Health District

- * Seed final cover
- * No vehicular traffic over Drain field area
- * Pump will be Required.
- * pump Alarm Required
- * Septic Tank Filter is Required

1.30'



DISCLAIMER

This map does not represent a survey nor does it purport to show all easements or encroachments, if any.

NO WELLS WITHIN 100' 

ALL COVERS TO BE \leq 5 MIN/INCH

DIVERT ALL SURFACE WATER AWAY FROM DRAINFIELD AREA.

PREPARE SITE & INSTALL DRAINFIELD DURING DRY CONDITIONS.

42,381 10 SHEETS 5 SQUARE
 42,382 100 SHEETS 5 SQUARE
 42,383 100 SHEETS 5 SQUARE
 42,384 100 SHEETS 5 SQUARE
 NATIONAL

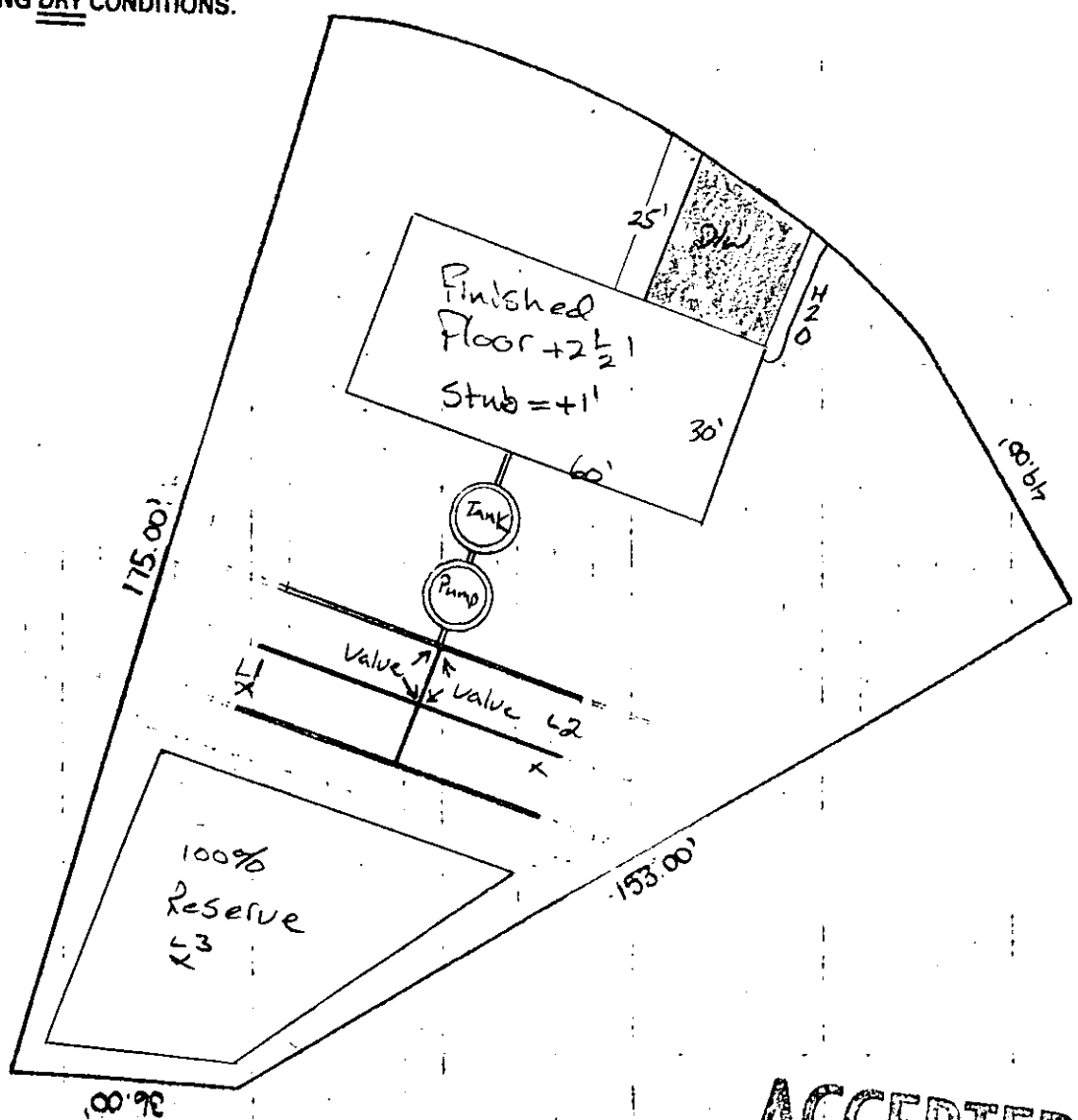

ACCEPTED

PRESSURE DISTRIBUTION WORKSHEET

PIPE: Class 200

A. DESIGN OF THE DISTRIBUTION SYSTEM

1. Select the orifice spacing = 2' ft.

2. Select the orifice diameter = 3/4 in.

3. Lateral length = $\frac{1}{2}$ of bed length - 0.5 ft.

$$= \frac{1}{2}B = 0.5 \text{ ft.}$$

$$= (\frac{1}{2} \times \underline{50} \text{ ft}) - 0.5 \text{ ft.}$$

$$= \underline{24.5} \text{ ft.}$$

4. # of orifices/lateral = $\frac{\text{Lateral length}}{\text{Spacing between orifices}}$

$$= \frac{\underline{24.5} \text{ ft.}}{\underline{2} \text{ ft.}}$$

$$= \underline{13}$$

5. Lateral diameter = 1" in.

6. Lateral spacing; # of laterals = 6 ft.

Distance between laterals = 9' ft.

Distance from outer laterals = 1.5' ft.
and edge of bed

7. Transport pipe diameter = 2" in.

8. Transport pipe length = 5' ft.

9. Manifold diameter = 2" in.

10. Manifold length = 18' ft.

B. DESIGN THE PUMPING SYSTEM

1. Dosing frequency/volume

a. Dose volume based on type of fill material = 90 gal.

- b. 10 times the interior volume of the part of the distribution system that drains after each cycle:

$$\begin{aligned} \text{Volume} &= 10 \text{ (# of laterals} \times \text{Length of lateral} \times \text{Volume/ft of pipe)} \\ &= 10 \left(\underline{6} \times \underline{24.5} \text{ ft} \times \underline{.058} \text{ gal/ft} \right) \\ &= 10 \times \underline{8.526} \text{ gal} \\ &= \underline{85.26} \text{ gal} \end{aligned}$$

- c. Choose larger of volumes in a or b above: 90 gal

2. Pump chamber size = 500 gal min

3. Pump selection

a. Required pump capacity = Orifice discharge rate x # of laterals x # of orifices/lateral

$$\begin{aligned} &= \underline{.59} \text{ gal/min} \times \underline{6} \times \underline{13} \\ &= \underline{46.02} \text{ gal/min} \end{aligned}$$

b. Pump head = Elevation difference + 2 ft residual head + Friction losses

$$\begin{aligned} &= \underline{5} \text{ ft of elevation difference} \\ &+ \underline{2} \text{ ft residual head desired} \\ &+ \underline{.19} \text{ friction loss in transport pipe in ft (see below)} \\ &+ \underline{0.6} \text{ ft of friction loss in distribution system} \\ &\underline{7.79} \text{ ft of total head against which the pump must pump} \end{aligned}$$

For friction loss:

| Diameter/Material | Length | Flow through Segment | Friction loss/100 ft | Friction Loss/Segment |
|-------------------|--------|----------------------|----------------------|-----------------------|
| 2" | 5' | 46.02 | 3.8 | .19 |

4. Select a pump that pumps the required flow at the calculated head:

Hydraulic SP. 33 or Equal
ALARM Required.

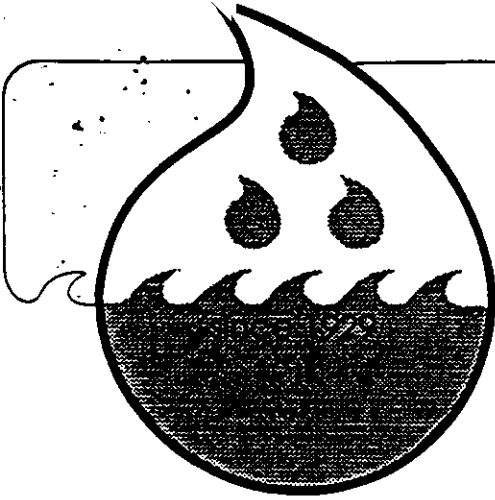

Silverdale Water District No. 16
9191 Bayshore Dr. P.O. Box 493 Silverdale, WA 98383
(206) 692-2604 FAX 692-2784

March 10, 1993

Rick Bearbower

Spot Realty

P. O. Box 1010

Silverdale WA 98383

RE: Water Availability Letter for Valley Hill Farms

Dear Rick :

The subject property is within the boundries of Silverdale Water District No. 16, (State Identification No. 181900), in Pressure Zone 3.

Water service to the subject property will be provided by Silverdale Water District No. 16 subject to the following conditions:

1. A satisfactory Developer Extension Agreement must be executed between the Developer and Silverdale Water District No. 16, and all the conditions of the extension agreement must be satisfied and all the charges must be paid.
2. Current charges shall be paid at the time of request for service.
3. The proposed development must meet the requirements of the Comprehensive Land Use Plan for Kitsap County.

Should you have any questions or need further information, please contact our office.

Sincerely,

Morgan Johnson
MORGAN JOHNSON
District Manager

3/16/93 - CF Morgan - system has been bonded - almost
Kitsap Public Health District *completes with installation - okay to release MR*

Bremerton-Kitsap County Health District
Water Supply Application Form

AA

Applicant's Name: John Loidehammer Date: 5-13-92
Building Site Application Designer: Dan A. Nyl
Parcel Location: Lot # 15 Valley Hills
(Legal discription, if short plat indicate number and lot).

Proposed Method of Water Service:

Public Water Supply

Existing: Name: Silverdale ID No.: _____
Water Availability Letter Attached: Yes _____ No

Proposed: Well Site Letter Attached: Yes _____ No _____
Coordinated Water Response Forms Attached: Yes _____
No _____

Individual Supply: Drilled Well: Proposed _____ Dug Well: Proposed _____
Existing _____ Existing _____
Spring: _____ Surface Water: _____ Other: _____

The Building Site Application (BSA) has been reviewed by a representative of the Bremerton Kitsap County Health District. A determination has been made by the District that soil conditions for installation of an on-site sewage system meet requirements of WAC 248-96 and Resolution 5 (1985). The BSA will be granted final acceptance by the District only after it has been demonstrated that an adequate and potable water source, as specified in Ordinance 2-1991 can provide service to the site. Failure to provide an adequate water source will result in denial of this application.

Nathan Johnson
Inspector's Signature

6/25/92
Date

The BSA has been reviewed by a representative of the Bremerton Kitsap County Health District. It has been determined by the District that site conditions for on-site sewage are not in compliance with WAC 248-96 and/or Resolution 5 (1985). Corrections must be made before further processing of the application can occur. The District will require that no action take place in regard to development of the drinking water source until it can be proven that the site is acceptable for installation of an on-site sewage system.

Inspector's Signature _____ Date _____

=====
This portion to be filled out once site conditions for the on-site sewage are in compliance and the water supply has been developed and designed to District standards.

A determination has been made by the Bremerton Kitsap County Health District that this Building Site Application is in compliance with design criteria for both on-site sewage and water supply.

Nathan Johnson 3/10/93
Inspector's Signature Date

3/10/93

Bremerton Kitsap County Health Dept. 478-5285

76426

Re-sub 3 to 4 Ban

Lot # 15 Valley Hills

pd 2500

OWNER: John Lair Hammer LEGAL: -OFF CLEAR Creek Rd

ADDRESS: 7412 Stanside Blvd NW Bremerton WA 98310

Single Fam. Resid. No. Bedrooms 4 New Constr. Remodel
 Multi-fam. Resid. No. Units: Exist. Bldg. Basement
 Mobile Home: new replacement Commercial
 Moved Bldg. Drainfield repair design Other

Indicate soil type, texture/description, restrictive layer, mottling, Perc. & Loading Rates, place plot plan and vicinity map on reverse side.

SOIL LOG # 1 <PRIMARY DRAINFIELD> SOIL LOG # 2

LR: .8 gpd/ft

LR: .8 gpd/ft

Depth Soil Type & Description
 0" Reddish Brown Loamy Sand
 24" Some Gravel
 32"
 36" Compact

Depth Soil Type & Description
 0" Reddish Brown Loamy Sand
 24" Some Gravel
 32"
 36" Compact

LOG # 3 <FOR RESERVE> LOG # 4
 LR: .8 gpd/ft LR: gpd/ft
 0" Reddish Brown Loamy Sand
 24"
 32"
 36" Compact
 48"

| Perc. rates min/inch |
|----------------------|
| P-1 |
| P-2 |
| P-3 |
| P-4 |
| Ave |

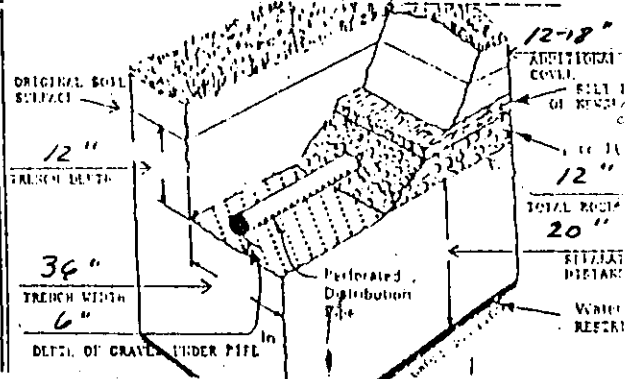

A. Depth to anticipated max. water table $\geq 32"$ % slope in DF. area 0-10%

B. The anticipated SEWAGE FLOW based on 120 gpd/bedroom is: 480 gpd. (B)

C. Loading rate average of SL #1 & SL #2 = .8 } Ave. LR = .8 gpd/ft (E)

D. Average perc. rate = loading rate of DRAINFIELD: B / E = 600 P Sq. ft. of drainfield / 2 = 300' lineal ft. required for standard 2 ft wide drainfield trench or 200' ft. DF. for 3ft trench

Inches of fill is needed. 12-18" inches of cover over original ground. CURTAIN DRAIN: is not required. is required

WATER SUPPLY IS Private or public supply of Silverdale H₂O with connections authorized by

B.S.A./DESIGN submitted by Dan A. [Signature] 612-3993 on 2-5 1999 water system representative

SEWAGE DISPOSAL SYSTEM: DENIED for a four bedroom house. WATER SUPPLY: [Signature]

- * Seed final cover
- * No vehicular traffic over Drain field area
- * Pump will be Required.
- * Pump Alarm Required

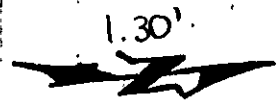

NO WELLS WITHIN 100' 
 ALL COVERS TO BE ≤ 5 MIN/INCH
 DIVERT ALL SURFACE WATER AWAY
 FROM DRAINFIELD AREA.
 PREPARE SITE & INSTALL DRAINFIELD
 DURING DRY CONDITIONS.

DISCLAIMER
 This map does not represent a
 survey nor does it purport to
 show all easements or
 encroachments, if any.

43,381 50 SHEETS 1 SQUARE
 43,382 50 SHEETS 1 SQUARE
 43,383 50 SHEETS 1 SQUARE
 43,384 50 SHEETS 1 SQUARE
 NATIONAL
 MADE IN U.S.A.

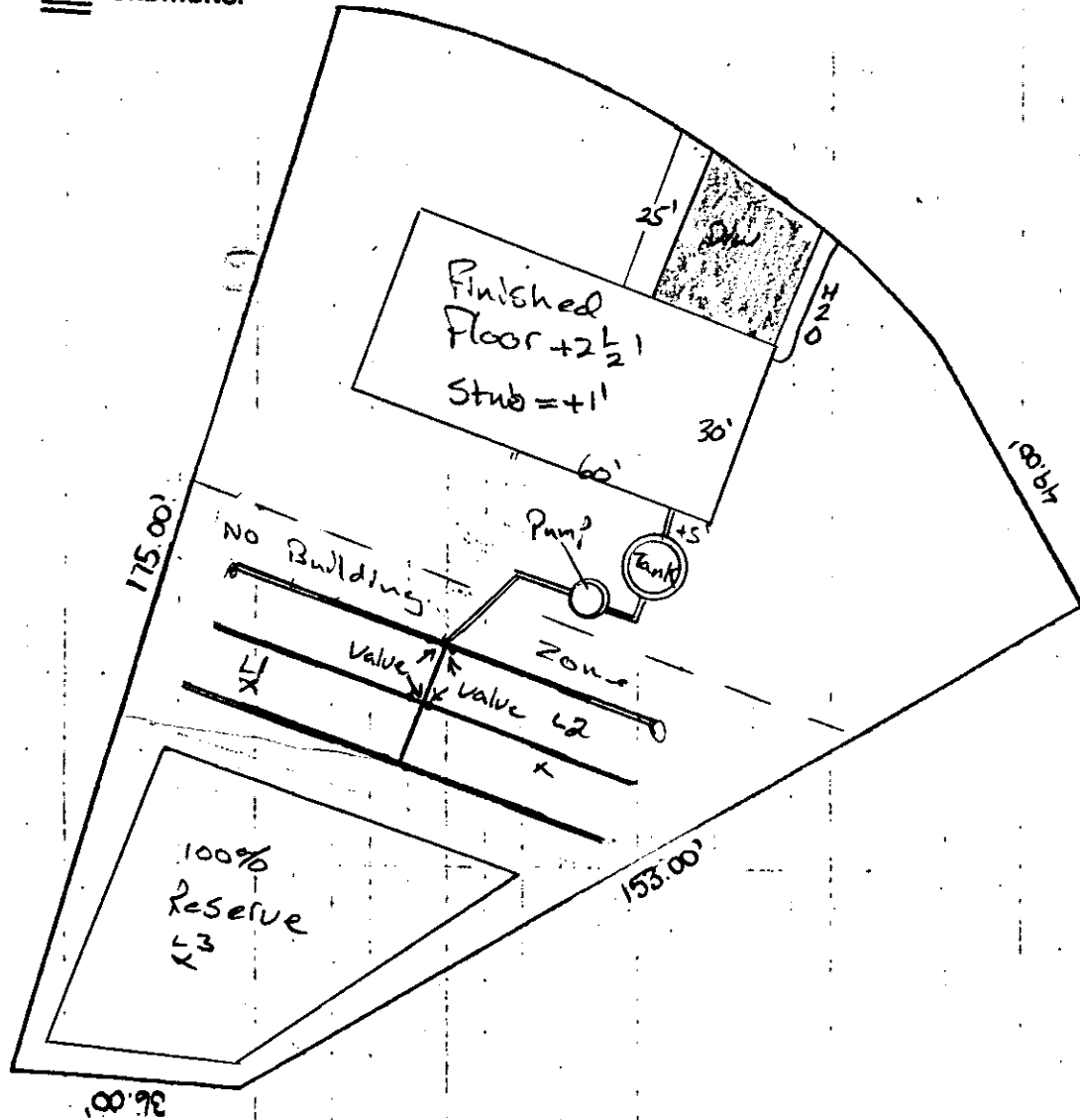

Bremerton-Kitsap County Health District
Water Supply Application Form

KIC

Applicant's Name: John Laidhammer Date: Feb 10, 93
Building Site Application Designer: Dave Ghylin
Parcel Location: Lot 15 Valley Hills off Clear Creek Rd.
(Legal discription, if short plat indicate number and lot).

Proposed Method of Water Service:

Public Water Supply

Existing: Name: Silverdale H²O ID No.: _____
Water Availability Letter Attached: Yes _____ No

Proposed: Well Site Letter Attached: Yes _____ No _____
Coordinated Water Response Forms Attached: Yes _____
No _____

Individual Supply: Drilled Well: Proposed _____ Dug Well: Proposed _____
Existing _____ Existing _____
Spring: _____ Surface Water: _____ Other: _____

The Building Site Application (BSA) has been reviewed by a representative of the Bremerton Kitsap County Health District. A determination has been made by the District that soil conditions for installation of an on-site sewage system meet requirements of WAC 248-96 and Resolution 5 (1985). The BSA will be granted final acceptance by the District only after it has been demonstrated that an adequate and potable water source, as specified in Ordinance 2-1991 can provide service to the site. Failure to provide an adequate water source will result in denial of this application.

X

Inspector's Signature

Date

The BSA has been reviewed by a representative of the Bremerton Kitsap County Health District. It has been determined by the District that site conditions for on-site sewage are not in compliance with WAC 248-96 and/or Resolution 5 (1985). Corrections must be made before further processing of the application can occur. The District will require that no action take place in regard to development of the drinking water source until it can be proven that the site is acceptable for installation of an on-site sewage system.

William Johnson 3/15/93
Inspector's Signature Date

=====
This portion to be filled out once site conditions for the on-site sewage are in compliance and the water supply has been developed and designed to District standards.

A determination has been made by the Bremerton Kitsap County Health District that this Building Site Application is in compliance with design criteria for both on-site sewage and water supply.

Kitsap Public Health District _____
Inspector's Signature Date

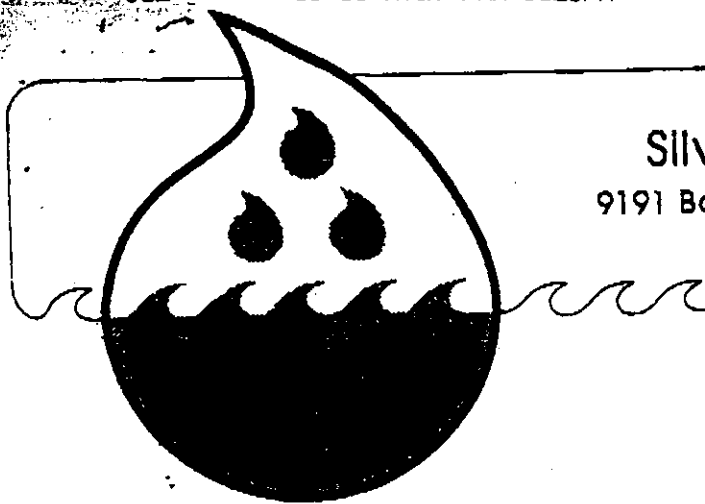

Silverdale Water District No. 16

9191 Bayshore Dr. P.O. Box 493 Silverdale, WA 98383
(206) 692-2604 FAX 692-2784

July 22, 1994

Mr. Ric Bearbower
8655 Anderson Hill Road N.W.
Silverdale, WA 98383

RE: WATER AVAILABILITY FOR TWELVE (12) SINGLE FAMILY RESIDENTIAL UNITS TO BE LOCATED ON LOTS 5-6-7-8-15-22-23-24-25-26-27 OF VALLEY HILL FARMS, SEE ATTACHED LOCATION MAP.

Dear Ric:

In response to your request for a water availability, the above referenced property is located within the service area boundaries of Silverdale Water District No. 16, Washington State System Identification Number 793006.

Silverdale Water District No. 16 has adequate facilities and source to provide water service to the referenced property. Water service is conditionally available to your property subject to the following conditions:

- Current charges shall be paid at the time of request for water service. Current charges for each residential unit is as follows:

| | |
|----------------------------------|------------|
| Capital Facilities Charge..... | \$1,205.00 |
| Service Installation Charge..... | \$255.00 |
| Front Footage Charge..... | N/A |
| ----- | |
| Total..... | \$1,460.00 |

- Compliance with the Comprehensive Land Use Plan for Kitsap County.

Should you have any questions or need further information, please do not hesitate to contact our office.

Sincerely,

MORGAN JOHNSON
District Manager

BUILDING SITE APPLICATION EXTENSION REQUEST FORM

Owner's name on BSA Bearbowen Lindhamer Date appvd 6/25/92
Assessor's Account # 5244-000-015-0008
Property location lot 15 Valley Hills
Original designer Davis
Applicant's mailing address _____ Phone# _____

WATER SUPPLY INFORMATION

PRIVATE: Existing well _____ Proposed well _____
PUBLIC: Current water availability letter must be attached.

Drinking Water Program Comments: _____

SEWAGE DISPOSAL SYSTEM INFORMATION

The proposed building site and soil conditions remain the same as when the Building Site Application was approved on _____.

I HEREBY CERTIFY that the proposed PRIMARY and RESERVE drainfield areas have not been compromised by any of the following:

- 1) ANY soil removed.
- 2) Wells or surface water developed within 100 feet.
- 3) Construction of any structures.
- 4) Construction of any driveways, roads, parking area or water lines.
- 5) Cut banks created within 50 feet.
- 6) Curtain drains installed within 30 feet.
- 7) New easements or property line adjustments within 10 feet.
- 8) Compacted soils by driving over or other means.
- 9) Any activity that would adversely impact the proposed drainfield area.

| | | |
|------------------------|--------------------------------|------------------|
| Applicant Name (print) | Signature | Date |
| _____ | _____ <i>Rick Bearbowen</i> | _____ 7-22-94 |

APPLICANT MUST BE PROPERTY OWNER, CERTIFIED DESIGNER OR INSTALLER

Liquid Waste Program Comments: _____



-90611
-New
Bsa

SCOTT W. LINDQUIST, MD, MPH, DIRECTOR
345 6TH STREET, SUITE 300
BREMERTON, WA 98337
(360) 337-5235

**NOTIFICATION OF MONITORING & MAINTENANCE REQUIRMENTS
FOR ALTERNATIVE ONSITE SEWAGE SYSTEMS**

April 13, 2009

Matthew & Celena Cruse
13800 Twilight Pl NW
Silverdale, WA 98383

System Type: Pressure Distribution
Disinfection Type: None

RE: MONITORING & MAINTENANCE COMPLIANCE CAMPAIGN:

Property Tax ID: 5244-000-015-0008
Property Address: 13800 Twilight Pl NW, Silverdale

Dear Property Owner:

Health District records indicate that you are the owner of the above address, and that this property utilizes an alternative type of onsite sewage system (OSS). Kitsap County Board of Health Ordinance No. 2008-08, require all alternative OSS to have a current Monitoring and Maintenance (M&M) contract, with a Health District certified M&M contractor, to ensure the proper monitoring and maintenance of the OSS.

Kitsap County Health District is engaged in a pre-enforcement notification campaign directed towards property owners who have not had an Monitoring & Maintenance (M&M) contract and an M&M inspection for their property at any time in the past, but need to come into compliance with Kitsap County M&M regulations.

The M&M contract and oversight of your alternative OSS is critical to protect both your property investment and public health. For more information please visit our website at <http://www.kitsapcountyhealth.com> or see the enclosed brochure.

In order for you to become compliant with the aforementioned regulation, the following items must occur:

1. Contact a certified Maintenance Specialist (see attached list) to establish a contract for maintenance of your onsite sewage system. Once you have selected and established your M&M contract with a service provider, they will submit the contract information to the Health District online. You may view your property/contract information by going to the following website: <http://www.kitsapcountyhealth.com>.

13800 Twilight

NOTICE AND ORDER TO CORRECT VIOLATION – M&M CONTRACT REQUIRED

April 13, 2009

Page 2 of 2

2. If the OSS is not completely accessible for maintenance it will need to be retrofitted. The Maintenance Specialist you contract with will need to determine the accessibility requirements for your OSS, and may assist you with the retrofitting upon request. A list of contractors that are certified to retrofit onsite sewage systems has been included with this mailing. It is always recommended that you receive at least 3 bids for service or get personal referrals before choosing a contractor. If you wish to complete the necessary retrofits yourself, we strongly recommend that you coordinate with your maintenance specialist to ensure that the job is done correctly and to code.
3. If a Notice to Title for "NOTICE FOR MAINTENANCE AND MONITORING REQUIREMENT KCHD ORDINANCE 2008-01 AND WAC 246-272-15501 (2)" has not been previously recorded with the Kitsap County Auditors Office the following must be completed:
 - a. Completely fill out the included Notice to Title (see enclosed instructions)
 - b. Record the Notice to Title with the Kitsap County Auditors Office.
 - c. Return a copy of the recorded Notice to Title to the Health District.
4. After the system has been retrofitted (if necessary) the contracted Maintenance Specialist needs to conduct an initial M&M inspection and submit the inspection report to the Health District.

Property owners who do not voluntarily comply with the above referenced regulation by June 13, 2009 will receive a follow-up enforcement letter, requiring compliance of the said regulations within 30 days. Failure to comply with the enforcement notification letter will result in the issuance of a civil infraction notice (i.e., a ticket) pursuant to Section 19.B.4.a.2., "Civil Penalties", of Ordinance No. 2008-01. The civil infraction notice may result in a fine of \$524 per violation per day.

If you have any questions or comments regarding this matter, or believe that this notice was sent to you in error, please contact the Health District at 360-337-5285, and request to speak to the Monitoring & Maintenance Inspector of the day.

Thank you for your cooperation.

Gregoria Noble, Environmental Health Technician
nobleg@health.co.kitsap.wa.us

bsj /enclosures

ONSITE SEWAGE MONITORING & MAINTENANCE:

Kitsap Public Health District
PROTECT YOUR FAMILY, PROTECT YOUR INVESTMENT, PROTECT YOUR ENVIRONMENT